

INTRODUCTION ELRO PRO PIR MOTION SENSOR AP55PR11:

The PIR Motion sensor AP55PR11 is designed for use with the ELRO 10-ZONE PRO ALARM SYSTEM AP5500.

PIR Motion Sensor:

PIR Sensors are designed to detect movement.

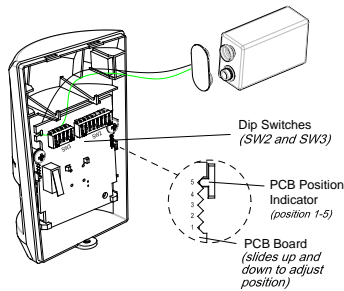

	DIP 1	DIP 2	DIP 3
Zone 1	OFF	OFF	OFF
Zone 2	OFF	OFF	ON
Zone 3	OFF	ON	OFF
Zone 4	OFF	ON	ON
Zone 5	ON	OFF	OFF
Zone 6	ON	OFF	ON

Insert the 9 Volt battery. The PIR will warm-up during 2-3 minutes. The LED will flash. When it is ready the LED stops. First check the house code: SW2; switch 1 – 8 (must be same as Remote Control). You can divide your detectors over your total home in zones. You can set the alarm zone the PIR detector will operate on, by switch the dip switches 1, 2 and 3 (of SW3; dipswitch 1-5) in the position according schedule above. Mark which zone number on the PIR. For walk test mode you put dip 4 of SW3 On. Don't forget to put back in Off. Test the PIR in the walk test mode. In normal mode the PIR will only send a mew signal after being triggered after 2 minutes

The PIR sensor incorporates an anti-false alarm for where the Sensor might be affected by e.g. insects, air temperature etc. We recommend high sensitivity, but in case of affection of (e.c. insects) , you can adjust dip 5 of SW3 to Off: low sensitivity detection!

Mounting the PIR motion sensor:

Household pets should not be allowed into an area protected by a PIR detector! Do not locate the detector facing a window facing direct sunlight. PIR Detectors are not suitable for use in conservatories. Do not locate the detector where it is exposed to ventilators. Do not locate the detector directly above a heat source, (e.g. fire, radiator, boiler, etc). Where possible, mount the detector in the corner of the room so that the logical path of an intruder would cut across the fan detection pattern. PIR detectors respond more effectively to movement across the device than to movement directly towards it. Where possible, mount the detector in the corner of the room so that the logical path of an intruder would cut across the fan detection pattern.

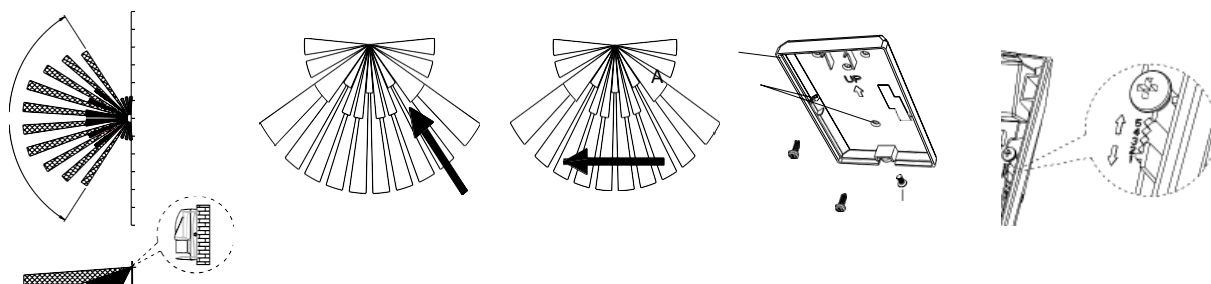

Less Sensitive



More Sensitive

A

1=6, 2=9, 3=12m

Carefully drill out the required mounting holes in the rear cover; A. Using the rear cover as a template, mark the positions of the fixing holes on the wall. Fix the rear cover to the wall. Detection area is adjustable up to 12 meter; you can move the PCB up or down. Check again if Dip 4 of SW3(dipswitch 1-5) in Off. In test mode the PIR will send after every trigger a signal. In the regular mode the PIR will pause 2 minutes, and then send again a signal after being triggered, to save batteries.

Programming the Alarm Panel:

Press ,  ? ? ? ?  (???? standard Master Password), display show 1.USER SETUP.

1. USER SETUP. Press , until in display: 3. ZONE SETTING. No we can choose:

Zone Setup (Z1-10) ; fill in the Zone Number you defined in the PIR motion sensor!

Name	No Name	You can select a room name, or leave 'no name'
Type	Intruder	Normal sensor will be 'intruder'.
Final Exit	OFF	'OFF'
Chime	OFF	'OFF'
Entry Delay Zone 1	ON, 30s	Depends if you have to pass the when you leave, or come back!
Zone 2-10	OFF	
Part-Arm 1	OFF	Do you want switch this sensor on in PARM1
Part-Arm 2	OFF	Do you want switch this sensor on in PARM2
Walk Through	OFF	'OFF'

After setting we leave the program modus: press  until you see in the display: DISARM READY

For more information about the ELRO 10-ZONE PRO ALARM SYSTEM AP5500 visit www.elro.eu

<p>ELRO Europe Postbus 9607 - Box E800 1006 GC Amsterdam The Netherlands</p>	 GUARANTEE www.elro.eu	<p>V1</p> <p>Symbols: Recycling and disposal: The WEEE symbol means that this product and batteries must be disposed separately from other household waste. When it reaches its end of life, take it to a designated waste collection point in your area to guarantee a safe disposal or recycling. Protect the environment, human health and natural resources!</p> 
--	---	--