

Safety Instructions

1. Keep the indoor unit away from high temperature such as near an oven or under direct sunlight, and high humidity such as bathroom and greenhouse
2. Do not install the indoor unit close to a television or position with strong jamming- the signals the TV and the intercom use can be interfered with each other
3. Do not touch the unit with wet hands.
4. Avoid throwing, dropping or hitting the units
5. Clean the camera or screen with a soft cloth. Do not use detergent, thinner, volatile or corrosive liquid
6. Do not expose the camera of the outdoor unit to direct sunlight
7. Use the product under the circumstance of barrier-free and no interference
8. When a car or a motorbike passes by, the image may become blurred or be cut off due to the interference of radio wave

Caution:

1. To prevent damage, the adapter should be fastened on the wall according to instruction
2. Power plug as disconnecting device should be kept convenient to operate

Symbols:

Recycling and disposal: The WEEE symbol (a) means that this product must be disposed separately from other household waste. When it reaches its end of life, take it to a designated waste collection point in your area to guarantee a safe disposal or recycling. Protect the environment, human health and natural resources! Read the manual (b) before use and store it in a safe place for future use and maintenance.

ELRO Europe | www.elro.eu
Postbus 9607 - Box E800
1006 GC Amsterdam - The Netherlands



GUARANTEE
Visit www.elro.eu



Manual EN

DV477W



VIDEO DOOR INTERCOM

7"/ 18cm MONITOR

Home is not a place, it's a feeling



Wired Video Door Intercom System

Congratulations on the purchase of your new ELRO Video Intercom System, featuring white light night view, wired outdoor unit with nameplate in full metal housing and a heavy metal rainshade, with manually adjustable camera and a 7" (18cm) brushed aluminium indoor monitor with 16 different melodies and adjustable volume.

We want you to be able to use this ELRO product without having to read an extensive guide, so this user manual will help you to get started, make the outdoor unit and indoor monitor work together and indicate the most important features.

If you need more detailed information, you can visit our website www.elro.eu for a service hotline and more details.

Product description and features

This ELRO Video Intercom System makes you feel safer and more comfortable when receiving visitors at your home. It has an outdoor unit finished in brushed aluminium with a protective heavy metal rainshade for surface wall mounting.

A pre-embedded box (ELRO DV47EB) for flush mounting is available as an accessory via www.elro.eu or through your retailer.

The 700 TVL manually adjustable camera with a 46° view angle comes with 6 real white LEDs for color night view in the dark for at least 2 meters in front of the camera. The outdoor unit also has a lit nameplate.

The 7" (18 cm) indoor monitor has a brushed aluminium front and 16 melodies/sounds to choose from. You can individually set the ring melody volume (H/M/L) and the speaking volume (stepless). You can also adjust the brightness and color intensity.

When someone rings the intercom, the monitor will play a melody or sound and show the camera picture. You can then observe, answer and/or open the door and the gate. The door opener can be connected to either the indoor monitor or the outdoor post.

Besides the mounting materials (mounting bracket for indoor monitor, dowels and screws) and user manual, the set contains the following parts:

Alternative

(A): Mounting the Outdoor Unit (Flush Mount)

If a surface mount is not appropriate (i.e. because you already have an appropriate hole in the wall or for aesthetic reasons) there is the option to mount your outdoor unit with a pre-embedded box. This is an optional accessory that you can find on our website www.elro.eu or purchase from the retailer where you bought the ELRO door intercom. The pre-embedded box has the ELRO Item number **DV47EB**.

To insert the cables from the back or any other side, you need to open one of the pre-arranged holes of the box. Next, fit the box neatly into the wall, screw it firmly and fix it with putty filler.

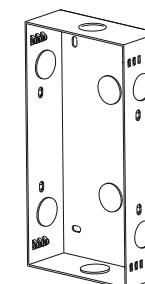

After that, follow the steps described in the surface mount section, but fasten the plastic body with 4 screws and the inbus screw of the aluminium alloy panel does not go through the box, but directly into the plastic body.

Specifications

Outdoor unit

Camera resolution	: 700 TVL
Camera angle	: 46°, manually adjustable
Power supply	: Over the indoor monitor
Working temperature	: -15°C - +50°C
Night view	: 6 x real white light LEDs, 2 meter
Dimensions	: 112 x 200 x 51 mm

Monitor

Screen size	: 7" (18 cm)
Resolution	: 800 x 480
Power supply (output)	: DC 12V, 2. A, 24W
Power consumption	: 2,5 W (standby) – max. 7,5 W
Adapter Input Voltage	: AC 100 – 240V; 50 - 60 Hz
Cable length	: Max. 50 m; 4 x 0,5 mm
Dimensions	: 215 x 152 x 18 mm
No. Of melodies	: 16

Adding a Door Lock

With this system you can also control the lock of a door or gate. An electric door or gate lock is connected to at least 2 x 0.1 mm² cables, available at every DIY store.

Note: Check carefully who you give permission to enter your home.

Connect an optional electric door opener to terminals 5 and 6
Connect an optional electric gate opener to terminals 7 and 8

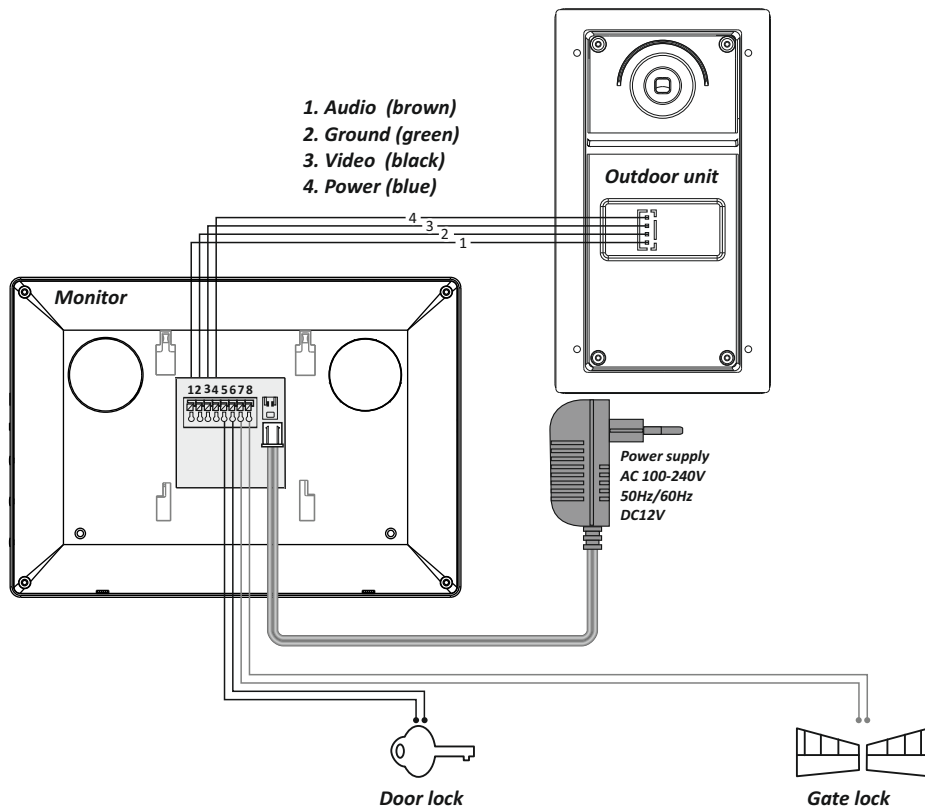

Outdoor unit

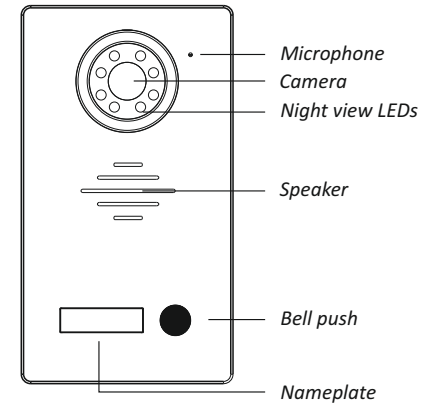

Rainshade

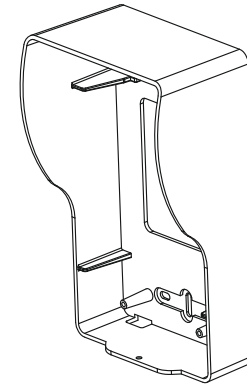

2x Monitor 7"/18cm

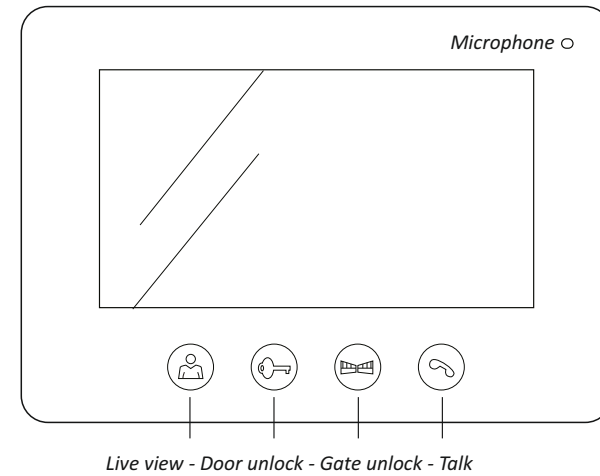

Side view monitor

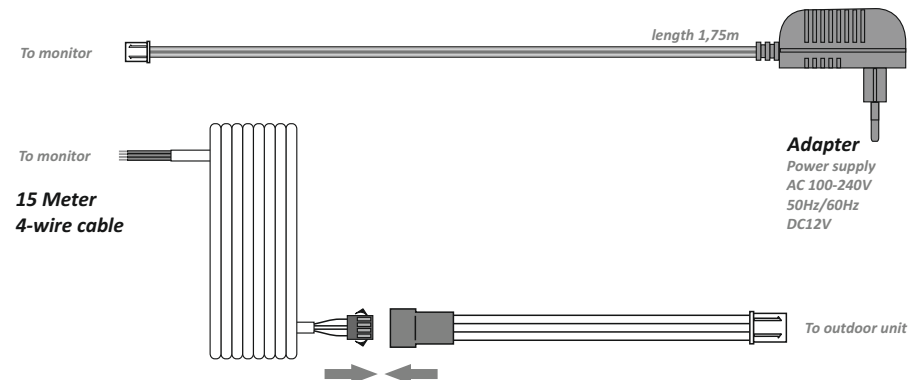
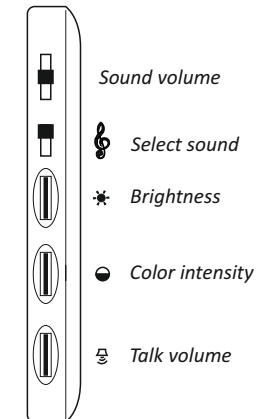

Installing Your Video Doorphone

A: Mounting the outdoor unit (surface mount)

1. Take the rainshade and use it to mark the drilling holes on your wall. Make sure that you are able to reach this place from the back with the 4-wire connection cable (and the door lock cable if applicable) to link it to the monitor. We recommend a mounting height of between 1,35 and 1,70 meters. Try to avoid direct sunlight or rain as much as possible.
2. Put the 4-wire cable with the connector through the rectangular hole in the rainshade and connect the cable plug to the slot. If you want to use existing wires, make sure you have at least 4 x 0,5 mm and ask a professional electrician for support.
3. Optionally you can connect an electric door lock. To connect a door lock you always use 2 x 0.1 mm² cables. Refer to the wiring instructions diagrams in the "Adding a Door Lock" section.
4. Remove the aluminium alloy panel with the inbus screw; take out the name plate paper, note your name and put it back in. Then put it into the rainshade with the top side first and fix it with 2 screws at the bottom.
5. Unfasten the screw behind the camera lens and manually move the camera into the desired position for the best view; then fasten the screw firmly.
6. Put the aluminium alloy panel back and fix it with the inbus screw through the hole in the rainshade.

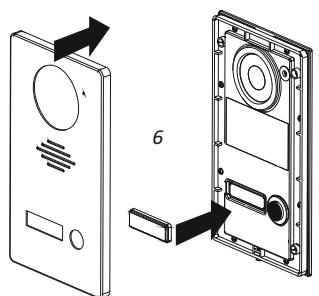
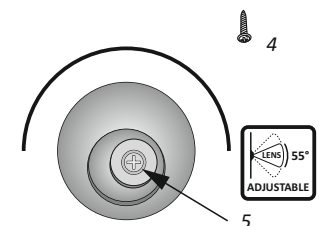
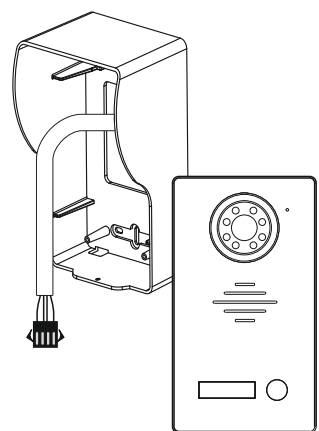
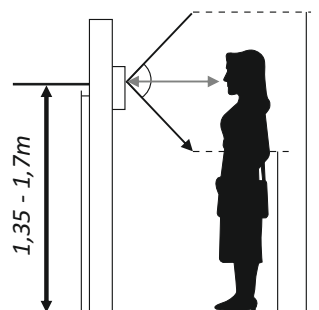

B: Mounting the indoor monitor

7. Use the mounting bracket to mark the drilling holes on your indoor wall and fix it to the wall, so that the 4-wire cable and the power cable (plus optionally an extra wire for door/gate lock) can go through from the back.

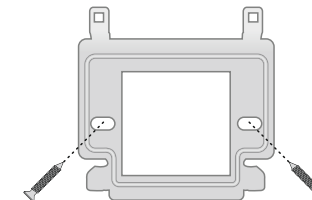

8. Connect the 4 wire cable to the slots number 1-4:

- 1 Audio wire (brown)
- 2 Ground wire (green)
- 3 Video wire (black)
- 4 Power wire (blue)

The wires must be in the same order as in the outdoor unit (check wiring diagram in the "Adding a door lock" section for details)

9. Lastly insert the power cable and hang the monitor on the mounting bracket. Your new Video Door Intercom is now ready for use. In case you want to use existing wiring, ensure you have at least 4 x 0,5 mm² and keep the maximum length of the cables below 50 meters.

Functions of the Indoor Monitor

When a visitor rings the bell, the chosen ringtone will sound and the picture will appear automatically on the monitor. You can then talk to the visitor by briefly pressing the TALK button of the monitor. By pressing the DOOR UNLOCK or the GATE UNLOCK button, you can unlock your door or gate. If you want to view the picture from the camera without someone having rung the bell, you can press the LIVE VIEW button to see the live picture for approx. 40 seconds.



Live view



Door unlock



Gate unlock



Talk

With the buttons on the side of the monitor you can select your ringtone, change the ring and talk volume and adjust the brightness and color intensity of the screen, see page 2.